

TSA-PATTEN

Metal sleeve anchor

Cheville en tôle enroulée

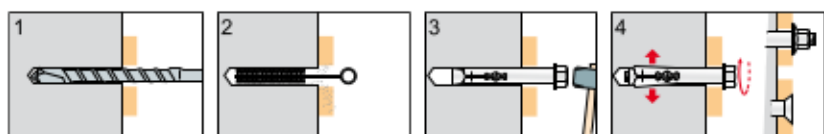

Hex head screw grade 8.8 white zinc plated

Vis T.H. classe 8.8
zingué blanc

Code	Type	Plug Cheville Ø x L	Screw Vis	Fixing thickness Épais. à fixer max	Pkg.	Outerbox Cond.
79602b08045	TSA 8/08	8x45	M6	8	100	1000
79602b08060	TSA 8/23	8x60	M6	23	100	800
79602b08080	TSA 8/43	8x80	M6	43	50	200
79602b08100	TSA 8/63	8x100	M6	63	50	200
79602b08120	TSA 8/83	8x120	M6	83	25	300
79602b08140	TSA 8/103	8x140	M6	103	25	300
79602b08160	TSA 8/123	8x160	M6	123	20	240
79602b10060	TSA 10/15	10x60	M8	15	50	400
79602b10080	TSA 10/35	10x80	M8	35	50	300
79602b10100	TSA 10/55	10x100	M8	55	25	250
79602b10120	TSA 10/75	10x120	M8	75	20	120
79602b10140	TSA 10/95	10x140	M8	95	20	120
79602b10160	TSA 10/115	10x160	M8	115	20	240
79602b12070	TSA 12/17	12x70	M10	17	50	350
79602b12100	TSA 12/47	12x100	M10	47	25	200
79602b12130	TSA 12/77	12x130	M10	77	20	120
79602b12150	TSA 12/97	12x150	M10	97	10	120
79602b16070	TSA 16/03	16x70	M12	3	10	100
79602b16110	TSA 16/40	16x110	M12	40	10	100
79602b16150	TSA 16/80	16x150	M12	80	5	50



Hex socket countersunk head screw grade 8.8 white zinc plated

Vis avec tête fraisée à six pans
classe 8.8
zingué blanc

Code	Type	Plug Cheville Ø x L	Thread Filetage	Fixing thickness Épais. à fixer max	Pkg.	Outerbox Cond.
79603b08060	TSA 8/28	8x60	M6	28	100	1000
79603b08080	TSA 8/48	8x80	M6	48	50	800
79603b08100	TSA 8/68	8x100	M6	68	50	500
79603b10060	TSA 10/20	10x60	M8	20	50	500
79603b10080	TSA 10/40	10x80	M8	40	50	300
79603b10100	TSA 10/60	10x100	M8	60	25	400
79603b10120	TSA 10/80	10x120	M8	80	20	320
79603b12070	TSA 12/22	12x70	M10	22	50	300
79603b12100	TSA 12/52	12x100	M10	52	25	250